



# Rosedale Tower

*1700 Highway 36 West  
Roseville, MN 55113*

## Suite Availability:

### Suite 125

Suite Size: 420.0 RSF | Rate/SF: \$23.00/SF

### Suite 490

Suite Size: 1,401.0 RSF | Rate/SF: \$23.00/SF

### Suite 890

Suite Size: 820.0 RSF | Rate/SF: \$23.00/SF

## Amenities

- Large Building Conference Room (35 People)
- Small Building Conference Room (12 People)
- Break Room and Vending Area
- Gazebo for Outdoor Dining
- Card Access System
- Great Access from Highways I-35W and 36
- Great Views of Downtown St. Paul & Minneapolis Skylines
- Tallest Building in the City of Roseville
- Building is Owner Occupied
- Adjacent to Rosedale Shopping Mall
- Abundant Parking

# Suite 125

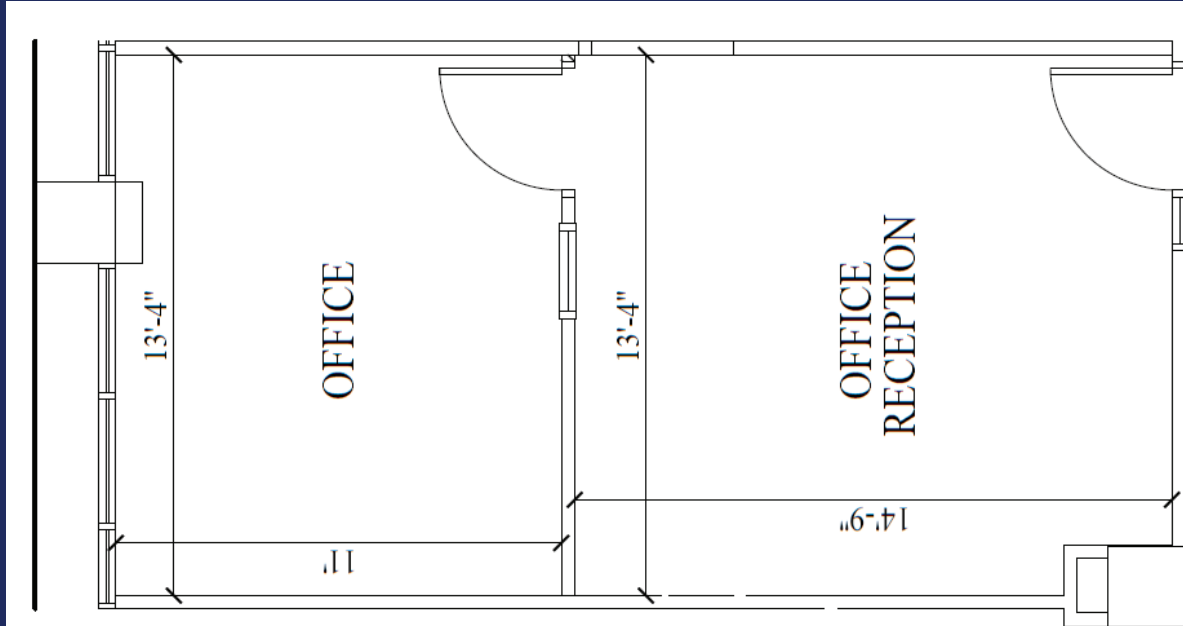

**SUITE 125**  
**420 R.S.F.**

## Suite Information:

Area - 420.0 RSF Rate/

SF - \$23.00/SF

## Includes:

- Basic Utilities
- Cleaning (5-Days/Week)
- Maintenance
- On-Site Management
- Conference Rooms

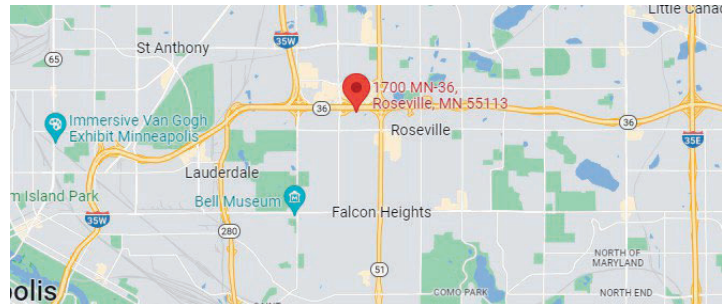

## Contact us:

Paul Buchmayer

Cell: (612) 269-2096

Licensed Real Estate Broker –  
Encompass Properties, LLC

[paulb@encompasspropertiesllc.com](mailto:paulb@encompasspropertiesllc.com)

Office: 651-361-8941